

Material: Steel music wire diameter = 0.032"  
 All bends are 90 degrees

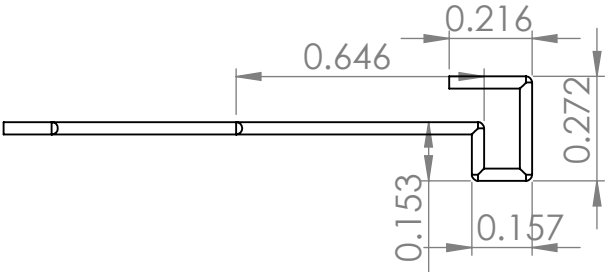
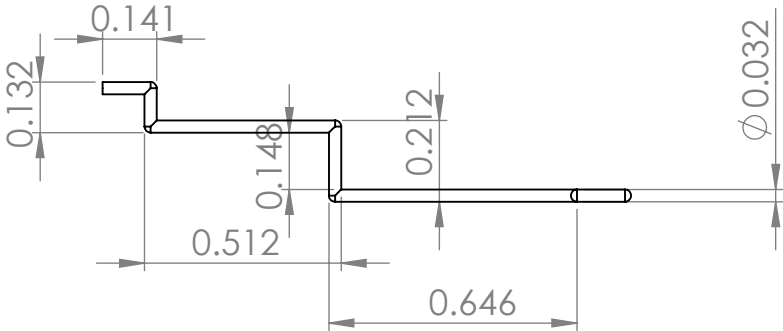
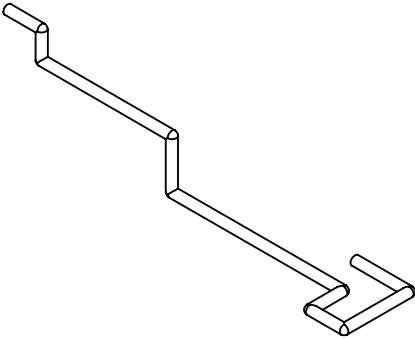

PROPRIETARY AND CONFIDENTIAL  
 THE INFORMATION CONTAINED IN THIS  
 DRAWING IS THE SOLE PROPERTY OF  
 XYZbot LLC. ANY  
 REPRODUCTION IN PART OR AS A WHOLE  
 WITHOUT THE WRITTEN PERMISSION OF  
 XYZbot LLC IS PROHIBITED.

		UNLESS OTHERWISE SPECIFIED:	NAME	DATE	
		DIMENSIONS ARE IN INCHES TOLERANCES: 0.005	DRAWN	kil	4/30/2013
		FRACTIONAL ±	CHECKED		TITLE: control wire vertical
		ANGULAR: MACH ± BEND ±	ENG APPR.		
		TWO PLACE DECIMAL ±	MFG APPR.		
		THREE PLACE DECIMAL ±	Q.A.		
		INTERPRET GEOMETRIC TOLERANCING PER:	COMMENTS:		
		MATERIAL steel music wire			SIZE DWG. NO.
		FINISH			A 12061
NEXT ASSY	USED ON				REV C
APPLICATION		DO NOT SCALE DRAWING			SCALE: 2:1 WEIGHT: SHEET 1 OF 1