

## HOW TO ASSEMBLE BUNNY BOT

Read instructions before cutting into the Bunny Bot sheet. Required materials: Bunny Bot sheet (printed in color or black and white), tape or glue, scissors

1. Cut out the individual Bunny Bot pieces. You can cut the black border off but it is not necessary to do so. Do not cut along the dotted lines on the body and do not cut the short black lines on the feet and arm pieces. You should have one head, two feet, one arm piece, one tail, and one body.

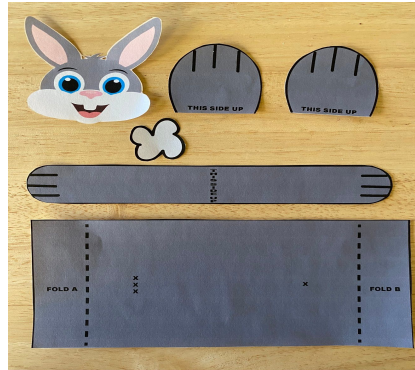

2. Grab the body piece and flip it over to the blank side. Fold Fold A and Fold B along the dotted line. Tape or glue Fold A to Fold B. Be careful not to crease the body.

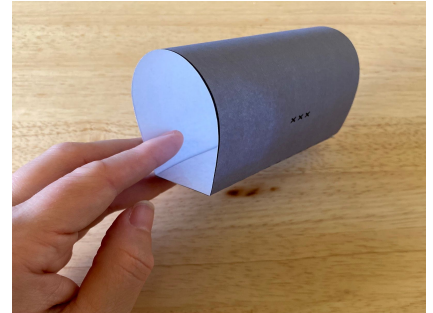
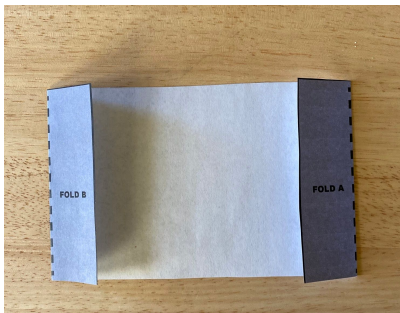

3. Locate the single X on the body. Tape or glue the tail to this X.

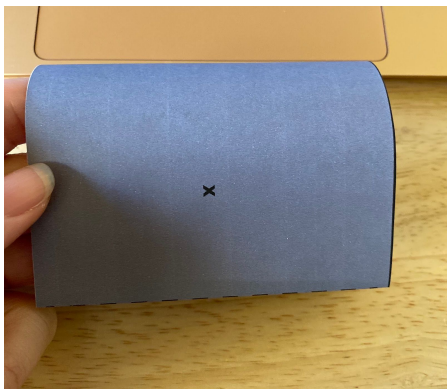

4. Grab the arm piece and place a piece of tape or glue to the middle where it says “This Side Up.” Have the body in front of you with the three Xs facing you. Slide the arm piece through the body until there is an equal amount of paper left on either side of the body and affix the arm to the inside of the body. Fold the arms towards the triple Xs and then open them back up.

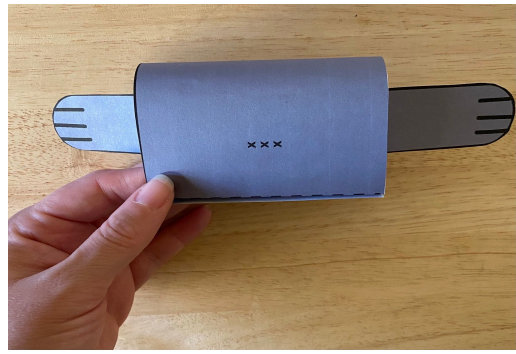

5. Grab the two feet pieces and put a piece of tape or glue where it says “This Side Up” and stick the feet onto the bottom of the body.

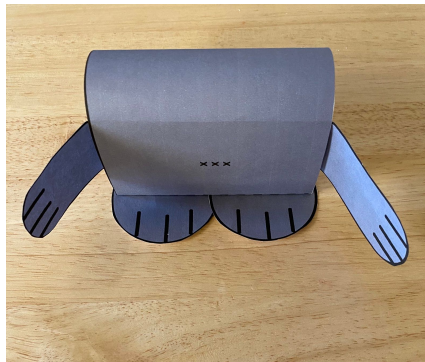

6. The last step is attaching the head. Place a piece of tape or some glue to the blank side of the head piece. Attach the head to the three Xs on the front of the body. All done! Enjoy your Bunny Bot!

