

LAURA'S HALL TABLE

My sister, Laura, didn't want anything "fancy" or overly expensive for a hall table in her new house but needed to fill a space.

Of course, "*not too fancy*" quickly became "*this specific thing I found on Pinterest*".

This isn't my original design - I don't know whose it is, I am just working off the one super low-resolution screenshot I was provided.

The dimensions are also designed to fit her space, not necessarily the dimensions I think would be best for most cases - this is a fairly narrow and chunk table, be aware of that if you've found people who run into furniture.

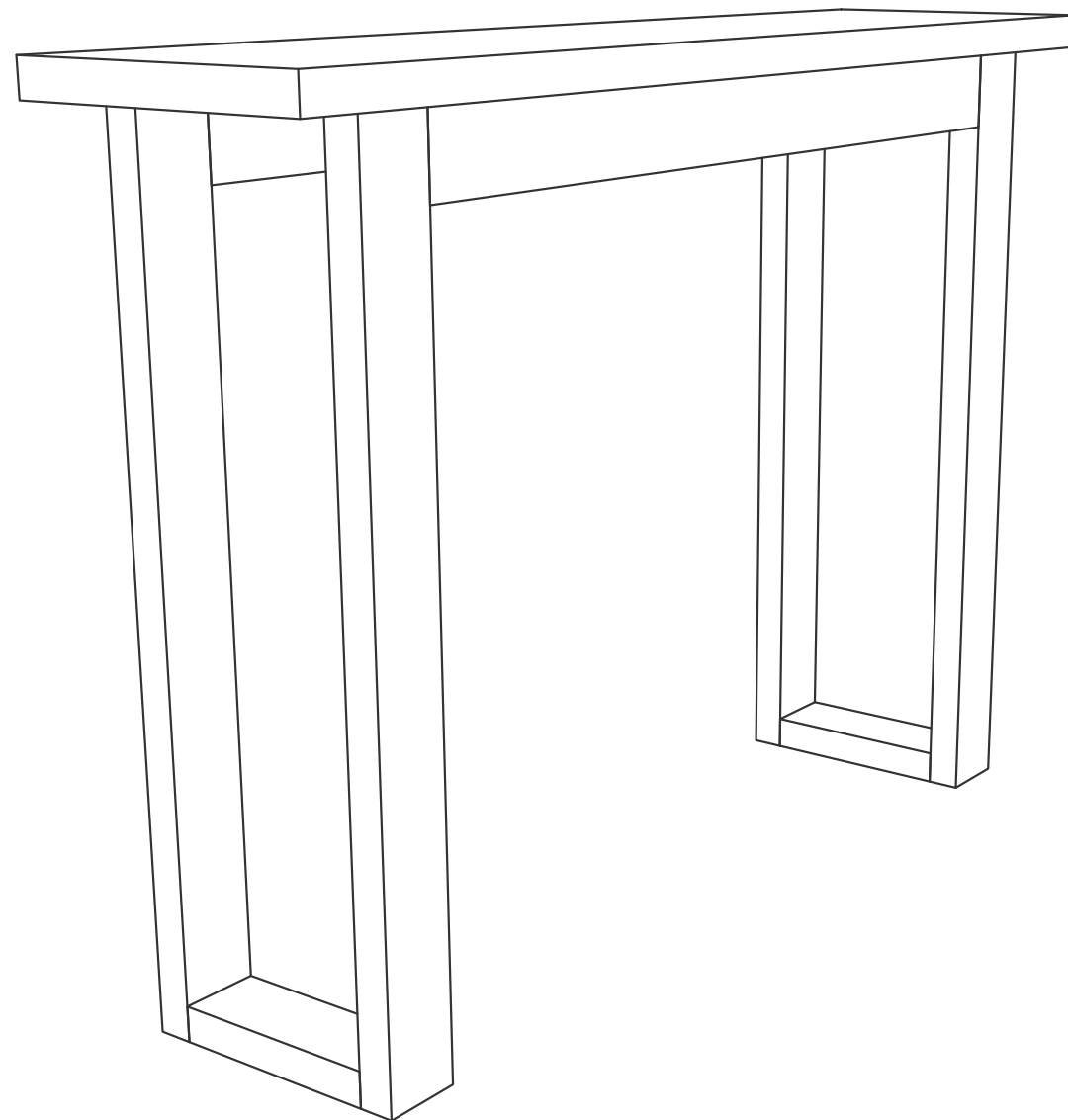



PARTS LIST - METRIC

Name	Length	Width	Thickness	Quantity
Top	1400 mm	350 mm	40 mm	1
Apron	1020 mm	90 mm	40 mm	2
Leg	960 mm	90 mm	40 mm	4
Short Stretcher	240 mm	90 mm	40 mm	2

PARTS LIST - APPROX IMPERIAL CONVERSION

Name	Length	Width	Thickness	Quantity
Top	55"	13-3/4"	1-1/2"	1
Apron	40"	3-1/2"	1-1/2"	2
Leg	37-3/4"	3-1/2"	1-1/2"	4
Short Stretcher	9-1/2"	3-1/2"	1-1/2"	2

MISC OTHER PARTS

Name	Note	Quantity
Z-Clips	To attach the top to the frame. Alternatively table top buttons, figure-8 clips, etc	4-6
Finish	"Occasional" tables like hall tables do not see frequent abuse like a dining table or desk, so are perfect candidates for "close to the wood" finishes. I tried out Livos' Kunos oil	

EXPLODED VIEW

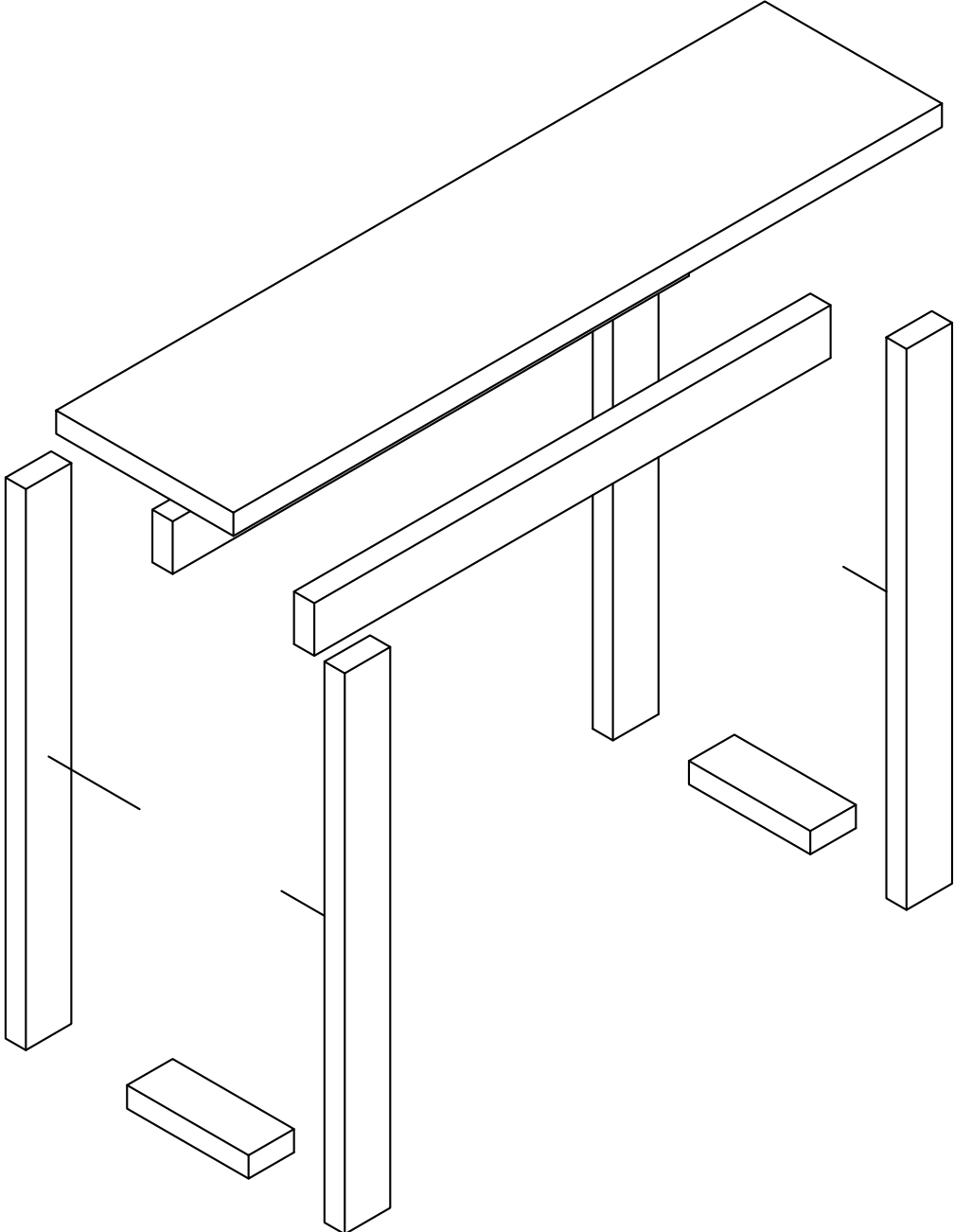

OVERVIEW

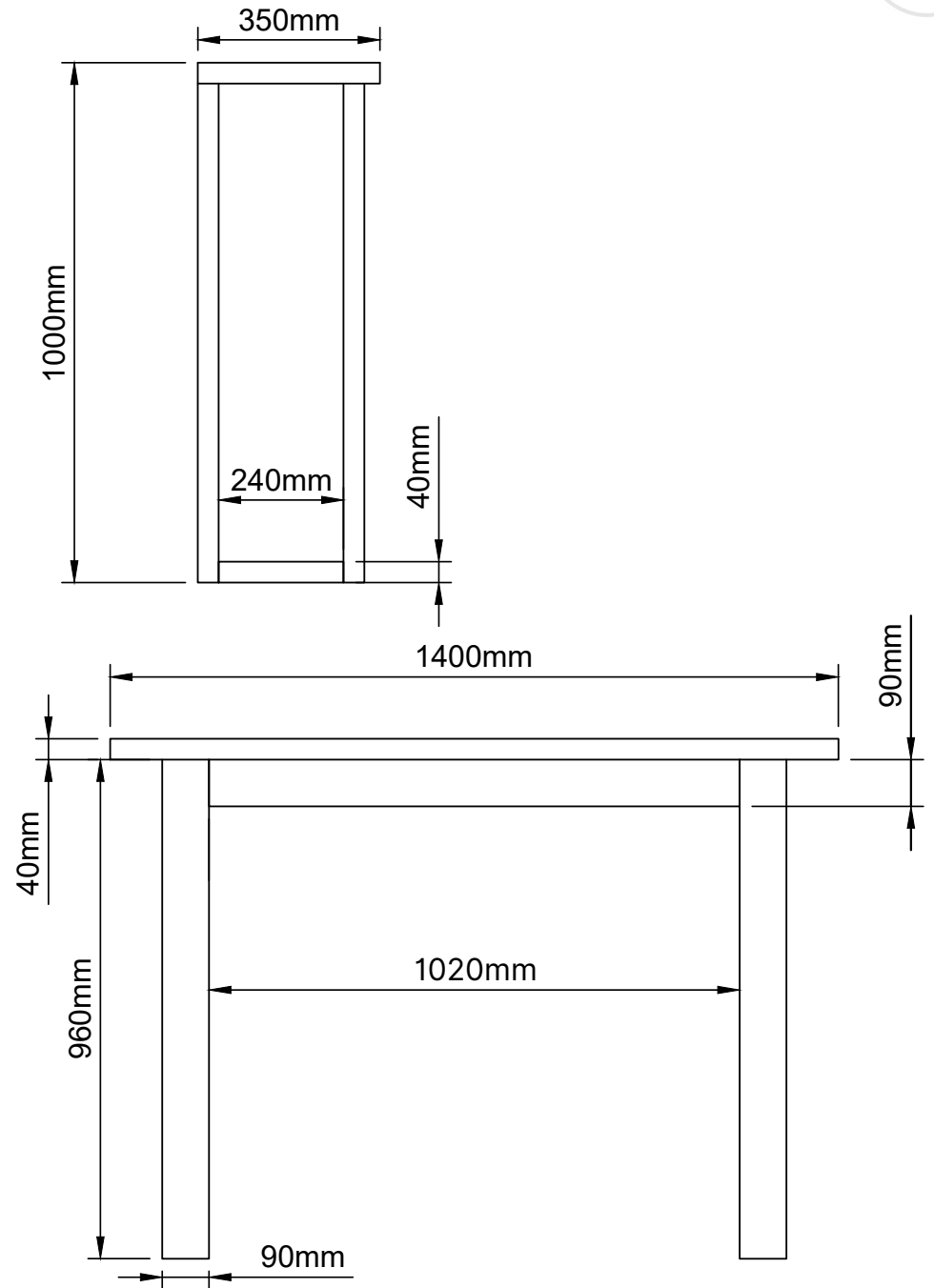

TOP

As I'm using rough sawn stock that starts as 140mm wide, to reach the required width I needed three boards.

For the glue lines, it stands out less if all the boards are the same width, so they were cut down into 117mm wide boards before glue-up.

If you have wider stock, adjust accordingly.

Dominoes or biscuits aren't **required** but they do make the glue-up easier, and help prevent the boards from shifting during clamp up. This is a very nice feature when you don't have a thicknesser/planer wide enough to handle 350mm/13-3/4"!

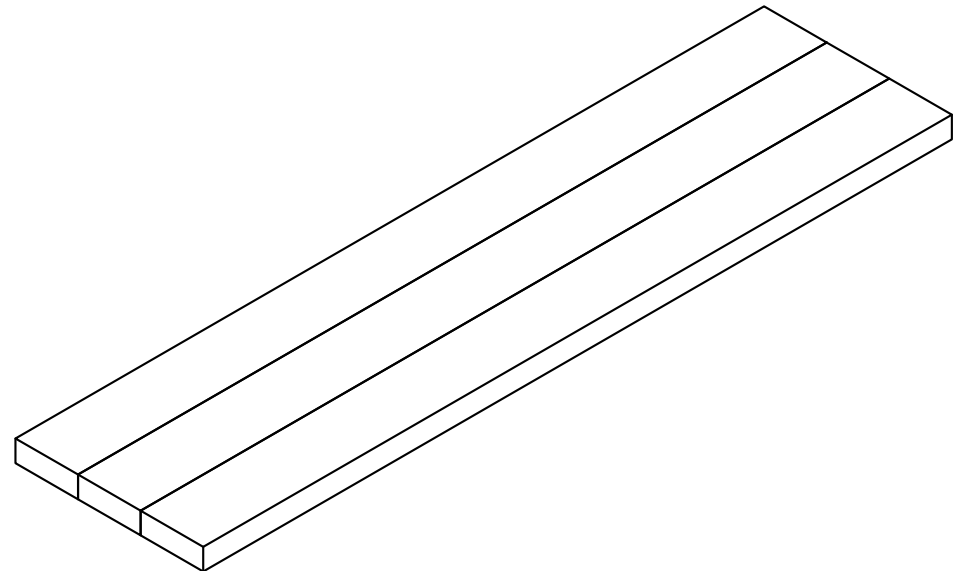
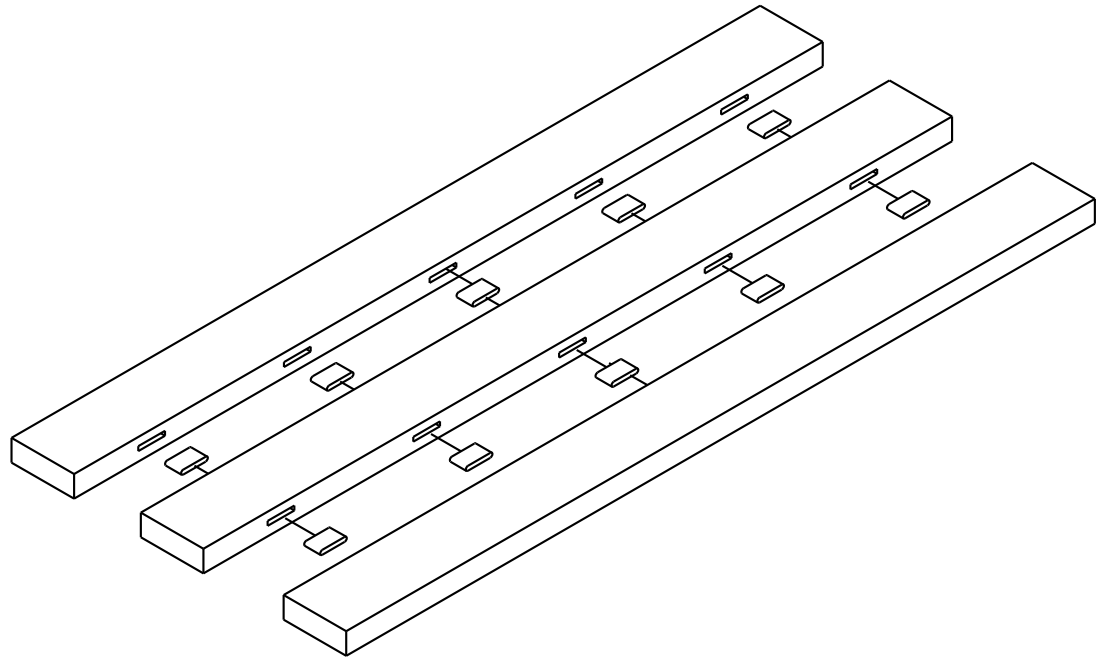

JOINERY

While integral mortise and tenon are absolutely fine, Dominoes (8x50) or dowels (8mm or 3/8") are perfect for this project.

The dimensions of each part - width and thickness - are all identical, so the layout for all the joinery can also be identical.

At each connection point, use four dominoes or dowels.

Why floating tenons/dowels?

Keep in mind the time this was constructed was during the COVID-19 pandemic, so I went with Dominoes for speed to hand off the hall table to my sister.



DOWEL LAYOUT

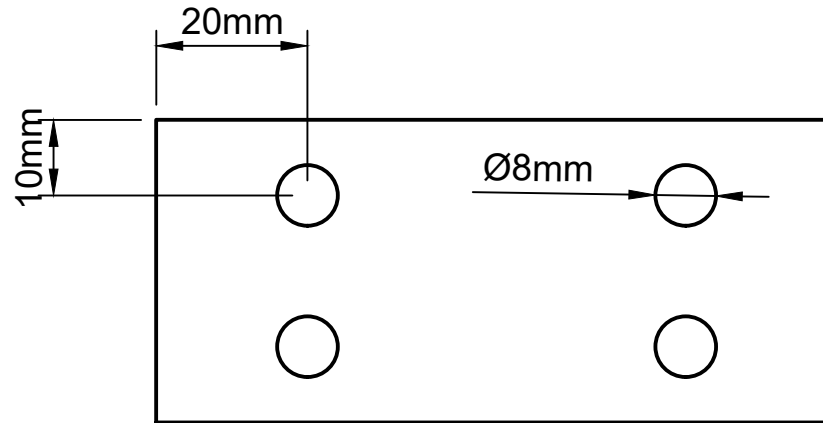

DOMINO LAYOUT

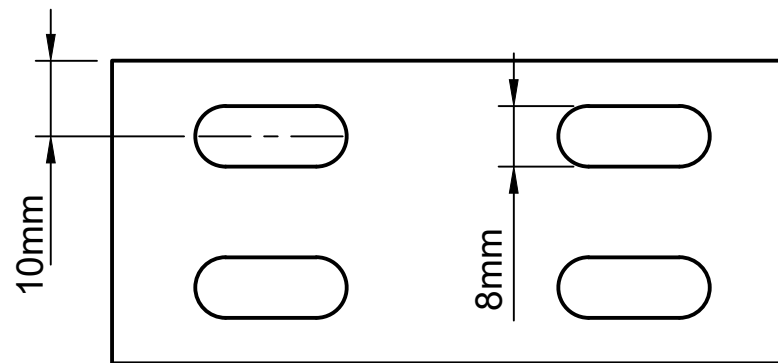

LEG ASSEMBLY

These unusual “U” shaped legs feel like they’re upside down.

If you’re feeling particularly fancy, you could mitre, box join or dovetail, however, Laura wanted just simple ‘butt joint’ look for the legs.

This project lends itself well to dowels or dominoes, though integral tenon and mortise will work too.

Create **two** of these assemblies.

Due to the awkward nature of these legs (weight and size), it is recommended to glue the two assemblies up separately.

You may want to make up a spacer (that isn’t glued) the same width as the “foot” section and clamp it at the top. This should help keep everything square,

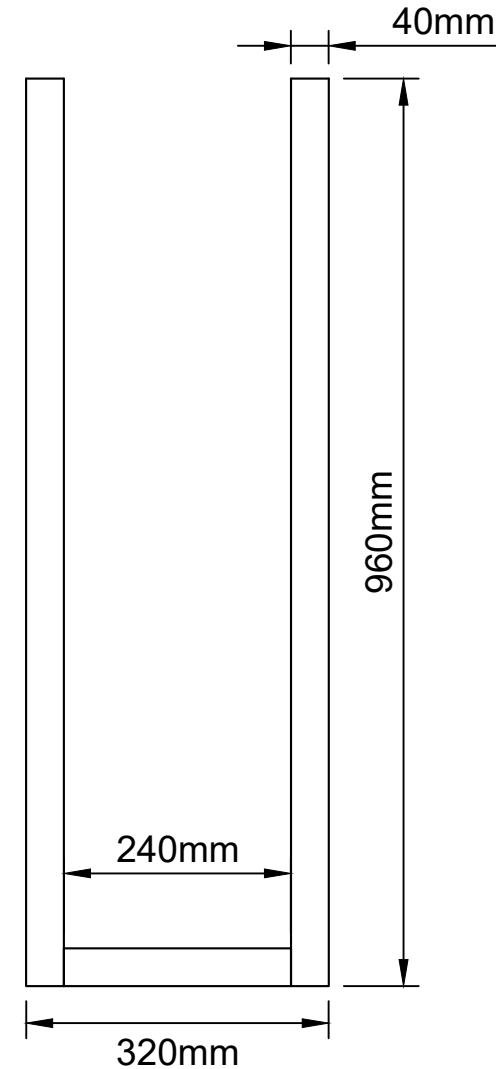

Part	Length	Width	Thickness	Quantity
Leg	960 mm	90 mm	40 mm	4
Foot	240 mm	90 mm	40 mm	2



APRONS & BASE ASSEMBLY

Before proceeding with the final base assembly, make sure that the slots for z-clips (or alternative) are already cut into the apron pieces. The narrow spacing will make it difficult to get tools in after glue-up.

After the two leg assemblies are glued, the aprons can be glued in to connect them.

With the aprons on a bench and the legs upside down, clamps can be added. The assembled base is 1200mm long, which is slightly longer than my longest clamps capacity - except for pipe clamps which can be extended nearly infinitely!

The same spacers from the leg assembly can be used to help ensure a square glue up.

Post glue up, z-clips can be installed to secure the top to the base, which will slightly increase rigidity as well.

EXAMPLE Z-CLIP PLACEMENT



FINAL GLUE UP

