

MummyBot Challenge

Intro to Robotics



instructables

MummyBot Challenge



Using what you've learned about electricity and circuits, you're going to give some life to a Mummybot with SMDs/LEDs!

Supplies

1. Mummybot template
2. Scissors, craft knife
3. Cutting mat, paper
4. Tape or glue sticks
5. SMD LEDs, LEDs
6. Batteries
7. Copper foil tape, conductive ink pens, conductive paint, wires

First Steps...

1. Cut out your Mummybot template.
2. Plan out your circuit paths:
 - a. where will your LEDs go?
 - b. Where will the battery go?
 - c. Which conductor will you use to make the paths?
3. When you have a good idea of placement, begin building your robot.

Do this in your
Engineering
Notebook

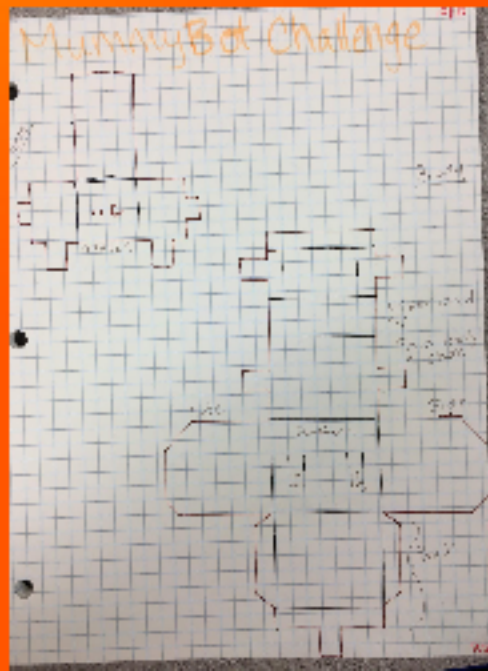

The Challenge...

Using what you've learned so far, bring your Mummybot to life. It must have:

1. Glowing eyes
2. An on/off switch

Additional requirements:

1. You must plan your Mummybot out in your Engineering Notebook.
2. Respond to challenge questions in notebook.

Notebook Questions

1. What type of conductor did you use to build your circuit? Why did you choose this conductor?
2. Did you try other conductors? If yes, why and what was the result?
3. Did you have any challenges with your Mummybot or the circuit? Explain.
4. What would you do differently?
5. What would you add to your Mummybot to make it more like a real robot?