

## The feature of Nozzle and Extruder

### The E3D V6 Y-head nozzle



#### 1) Consist of four parts:

A 20\*16\*11.5 heating block made up of 6061 frame

A Brass nozzle

A throat tube made up of 316F / stainless steel

A radiating tube

A plug for Teflon tube

A 30\*10 mm fan and plastic plug

A Thermocouple and a few screws

The inner structure is below:

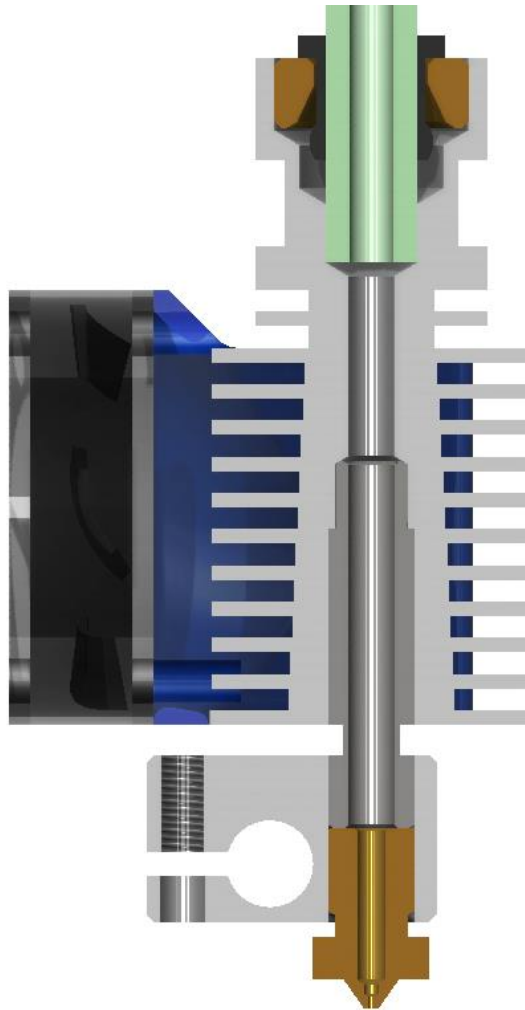

## The bowden extruder

Is compatible with E3D/ J-head/MK8 nozzle .

Can use 1.75mm and 3mm PLA but we use 1.75 mm here.

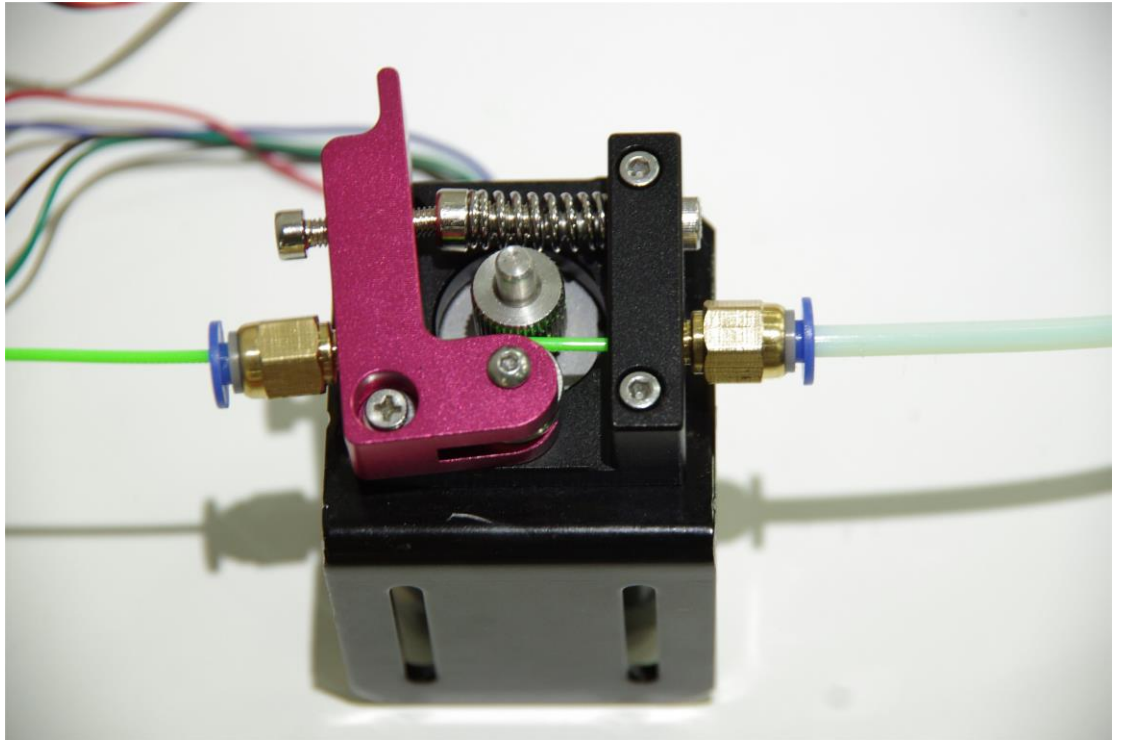

Here is a video about how to assemble one.

<https://www.youtube.com/watch?v=yLH4K1vNoXo>