

ITEM NO.	PART NUMBER	DESCRIPTION	QTY.
1	camasm		1
2	drop		1
3	top guide		1
4	bottom guide		1
5	bottom plate		1
6	Crank		1
7	Sidebar		2
8	Rim		1
9	Drive		1
10	CR-PHMS 0.112-40x0.5x0.5-N		10
11	RingAssem1		1
12	ROUND STANDOFF		1
13	SL-PHMS 0.112-40x0.75x0.75-N		1
14	CR-PHMS 0.138-32x0.75x0.75-N		12
15	Nylon Spacer		2

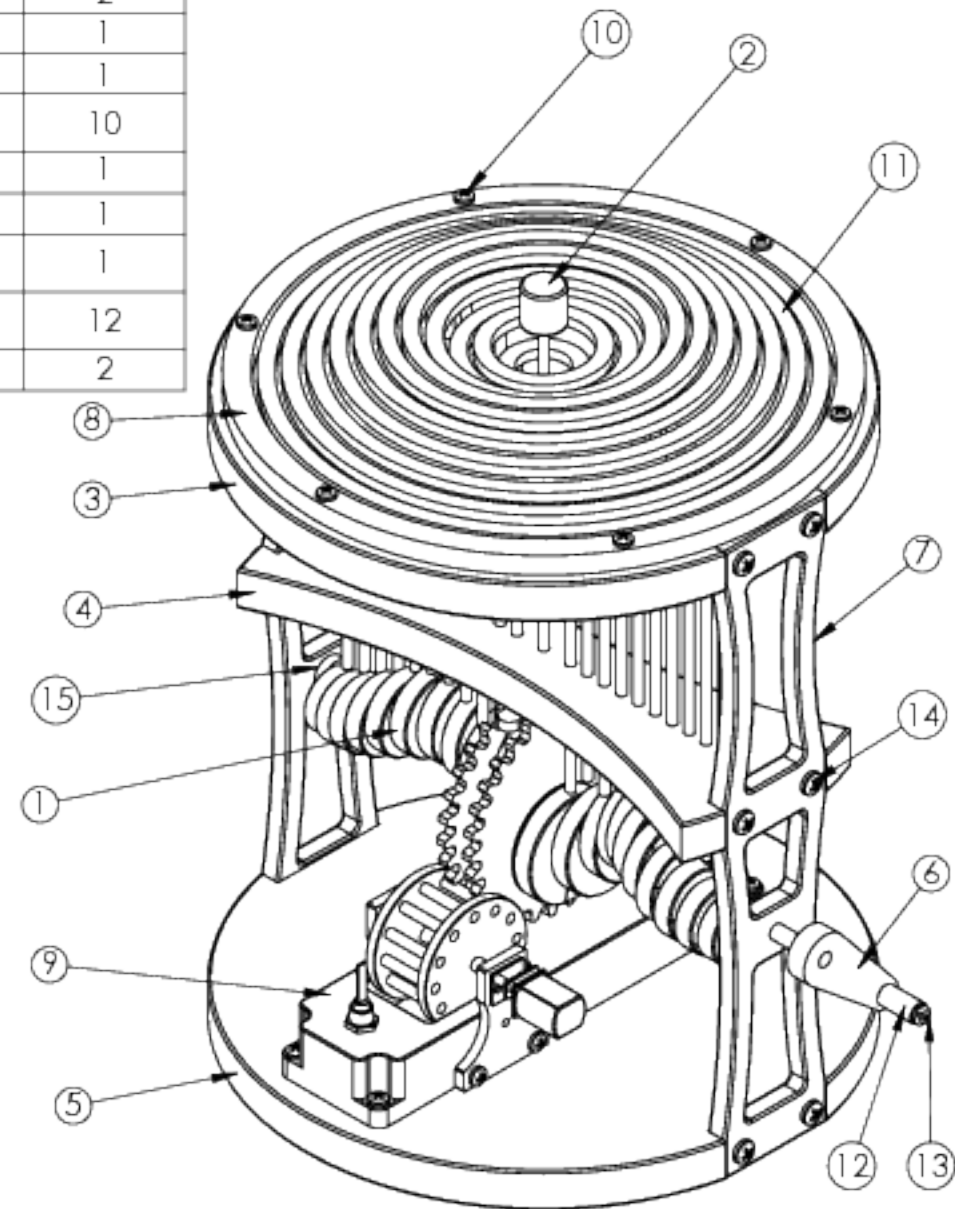

Parts List			
ITEM NO.	PART NUMBER	DESCRIPTION	QTY.
1		Drive box	1
2		Pin gear asm	1
3		drive shaft support	1
4		drive shaft support	1
5		motor	90 rpm, 12 volt dc
6		switch	dpdt, on/off/on
7		Drive shaft	1
8		CR-PHMS 4-40x0.3125	4
9		9V Battery	1
10		Switch Nut	1
11		Screw M1.6 x 5mm lg	2

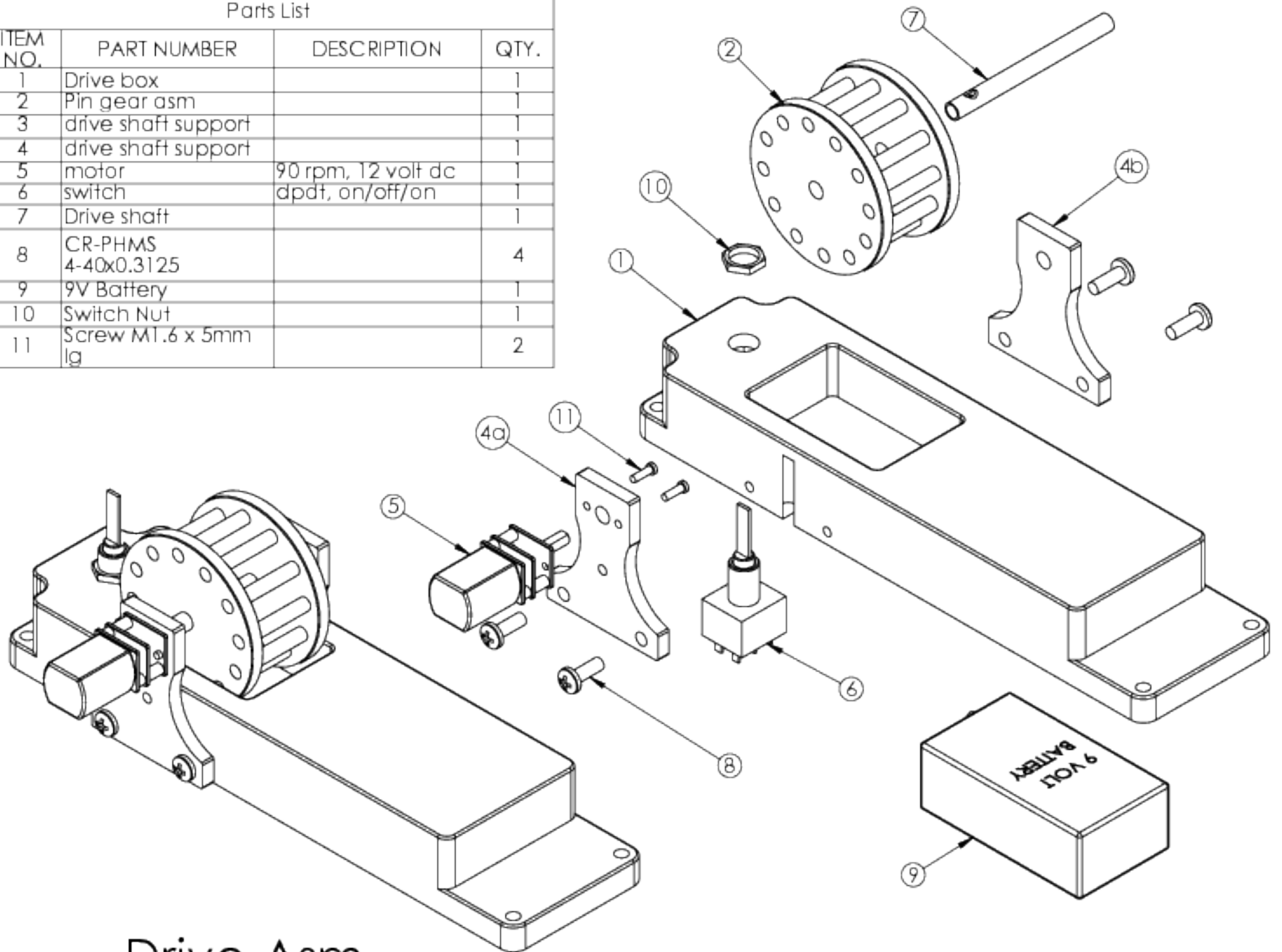

## Drive Asm

ITEM NO.	PART NUMBER	DESCRIPTION	QTY.
1	cam	Dia .75	2
2	cam	Dia .80	2
3	cam	Dia .85	2
4	cam	Dia .90	2
5	cam	Dia .95	2
6	cam	Dia 1.00	2
7	cam	Dia 1.05	2
8	cam	Dia 1.12	2
9	cam	Dia 1.18	2
10	cam	Dia 1.24	2
11	cam	Dia 1.34	2
12	cam	Dia 1.50	1
13	Rod	3/16 Dia dowel 9.5" lg	1
14	big gear		2
15	Cam Spacer		2

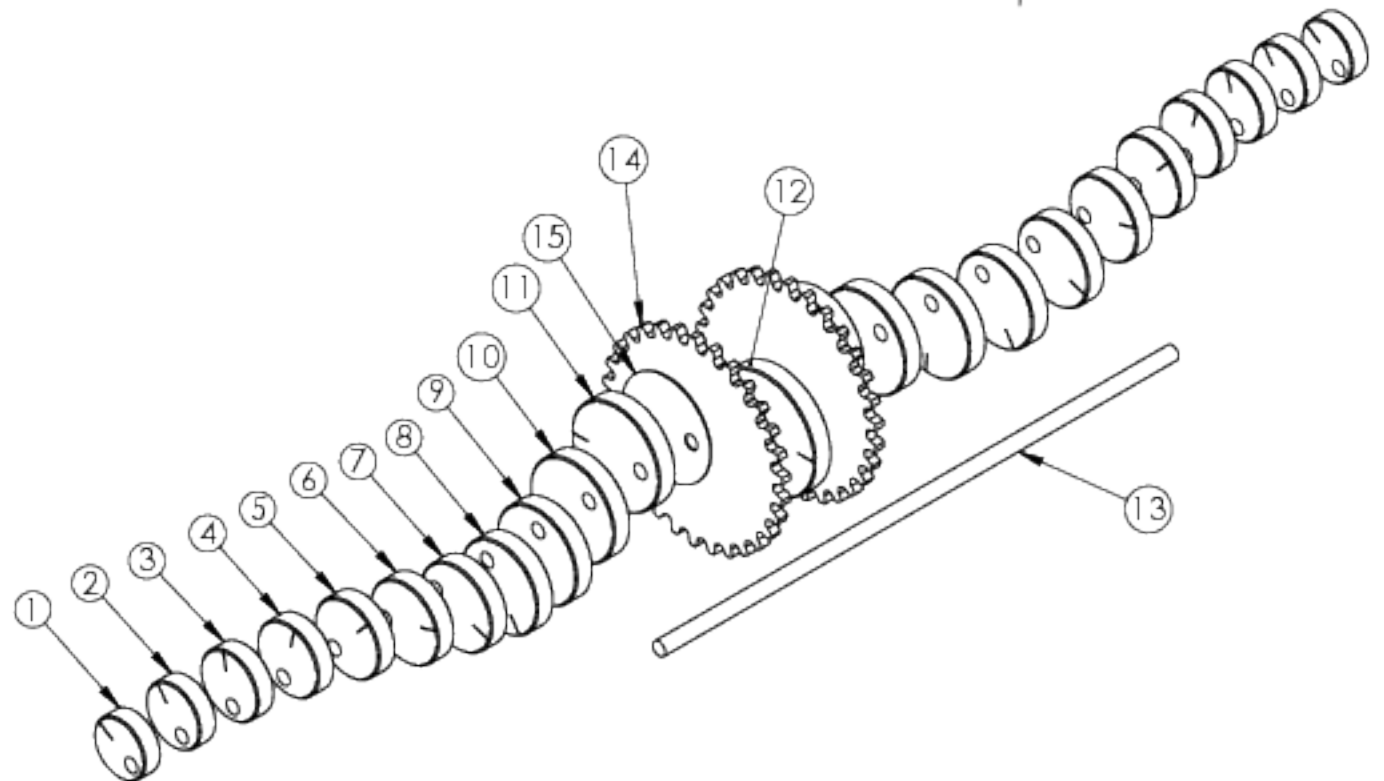
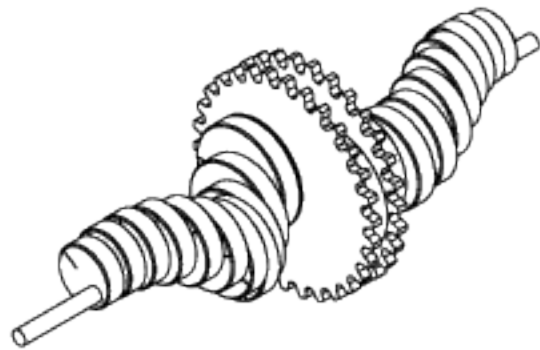
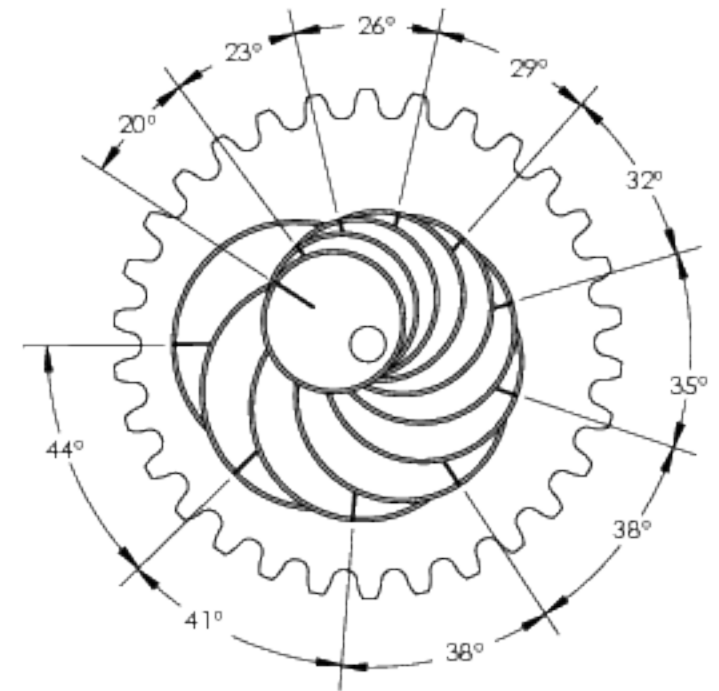

## Cam Asm

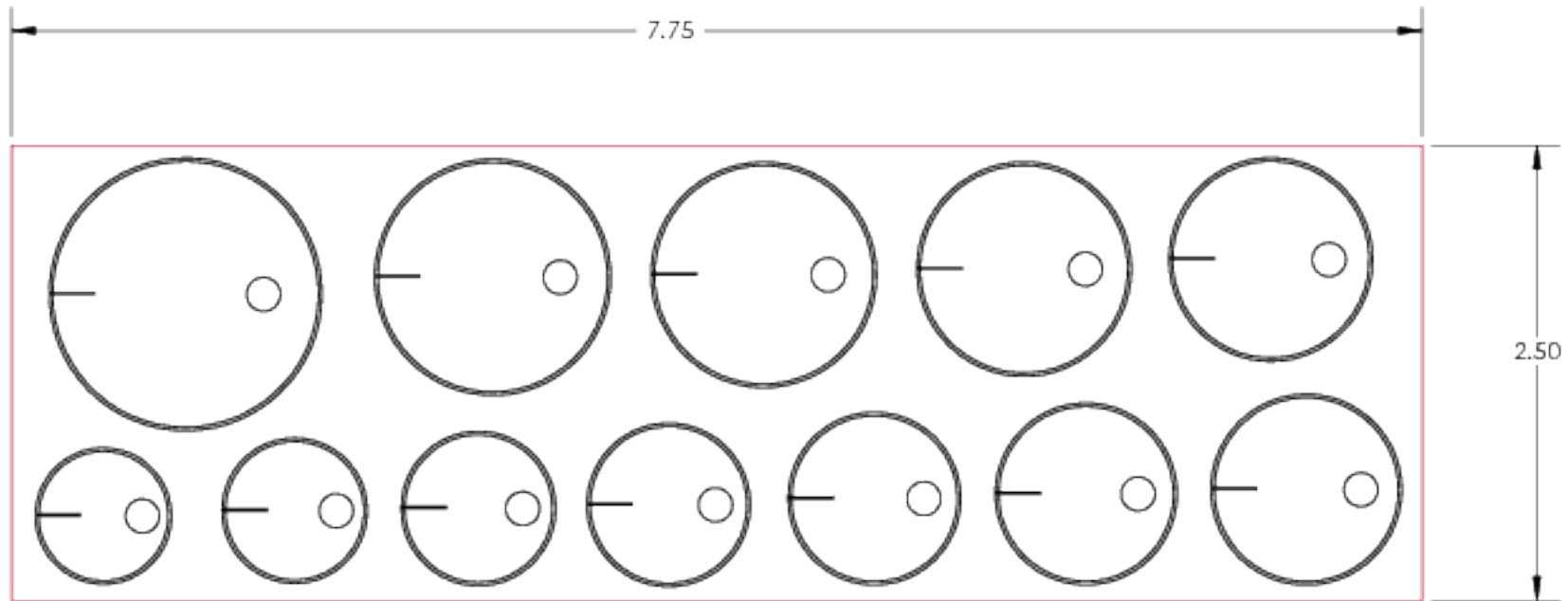

Cam cutting layout  
1/4" Oak

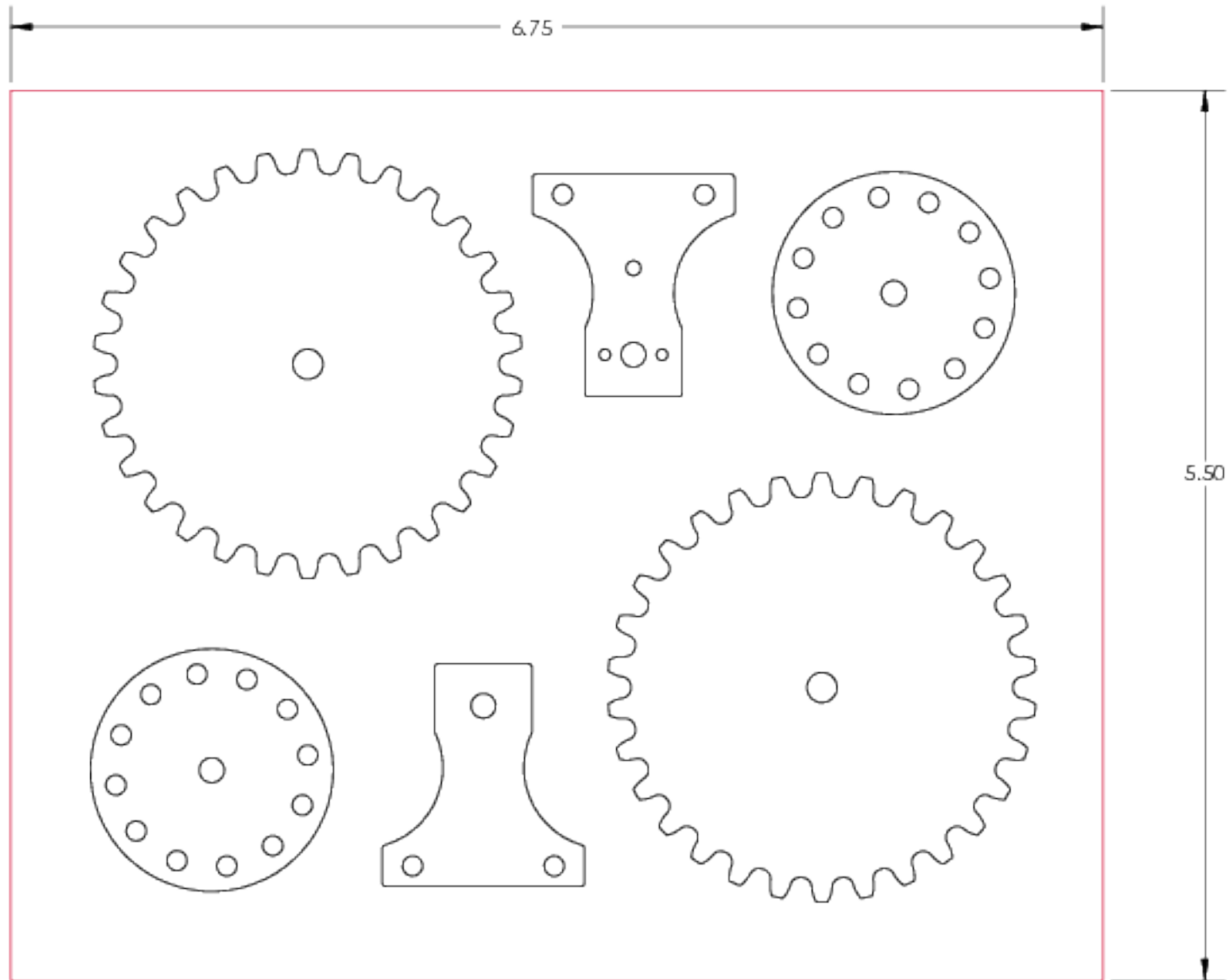

Motor drive parts cutting layout  
1/8" Baltic Birch

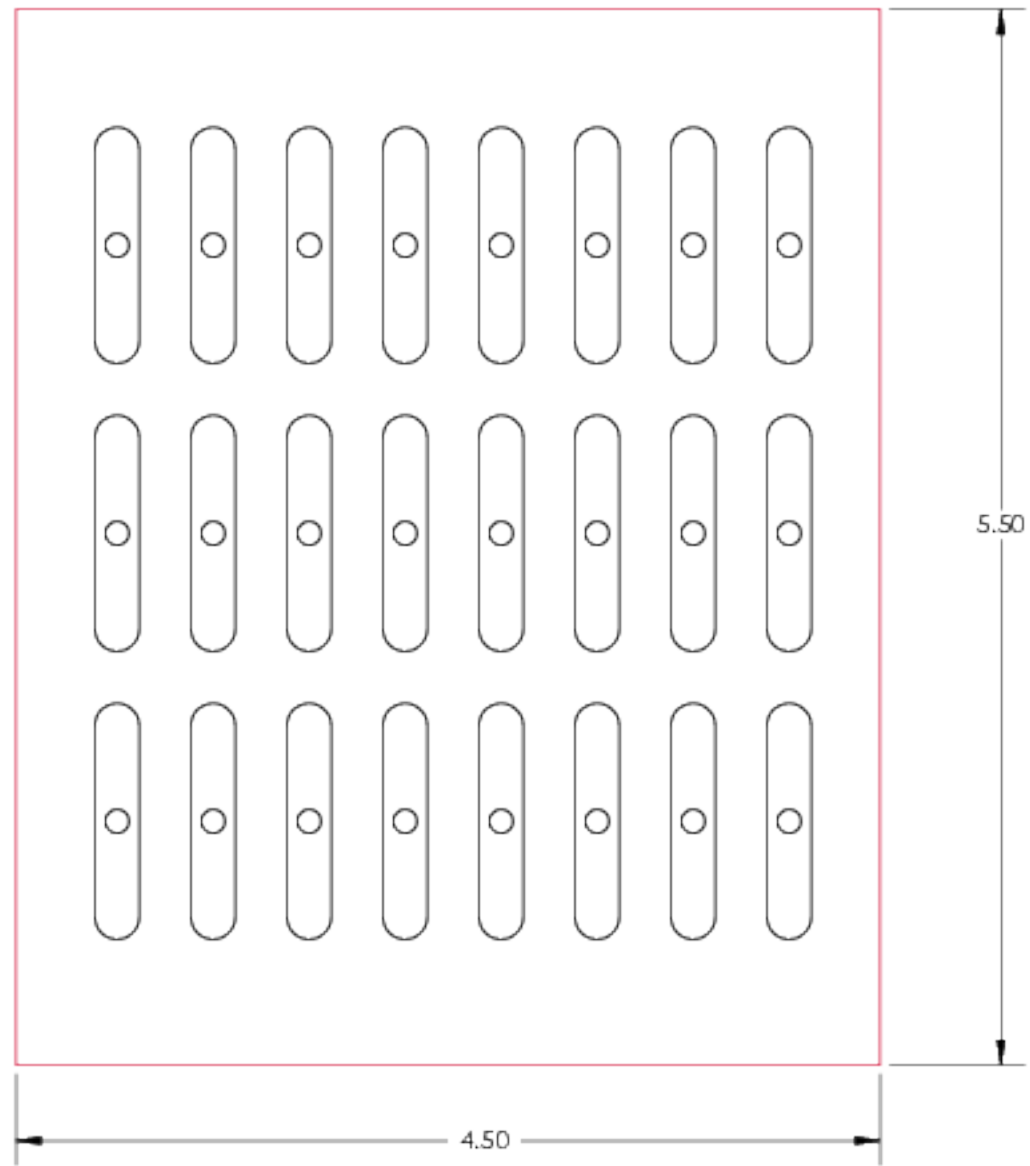

Foot cutting layout  
1/8" Baltic Birch

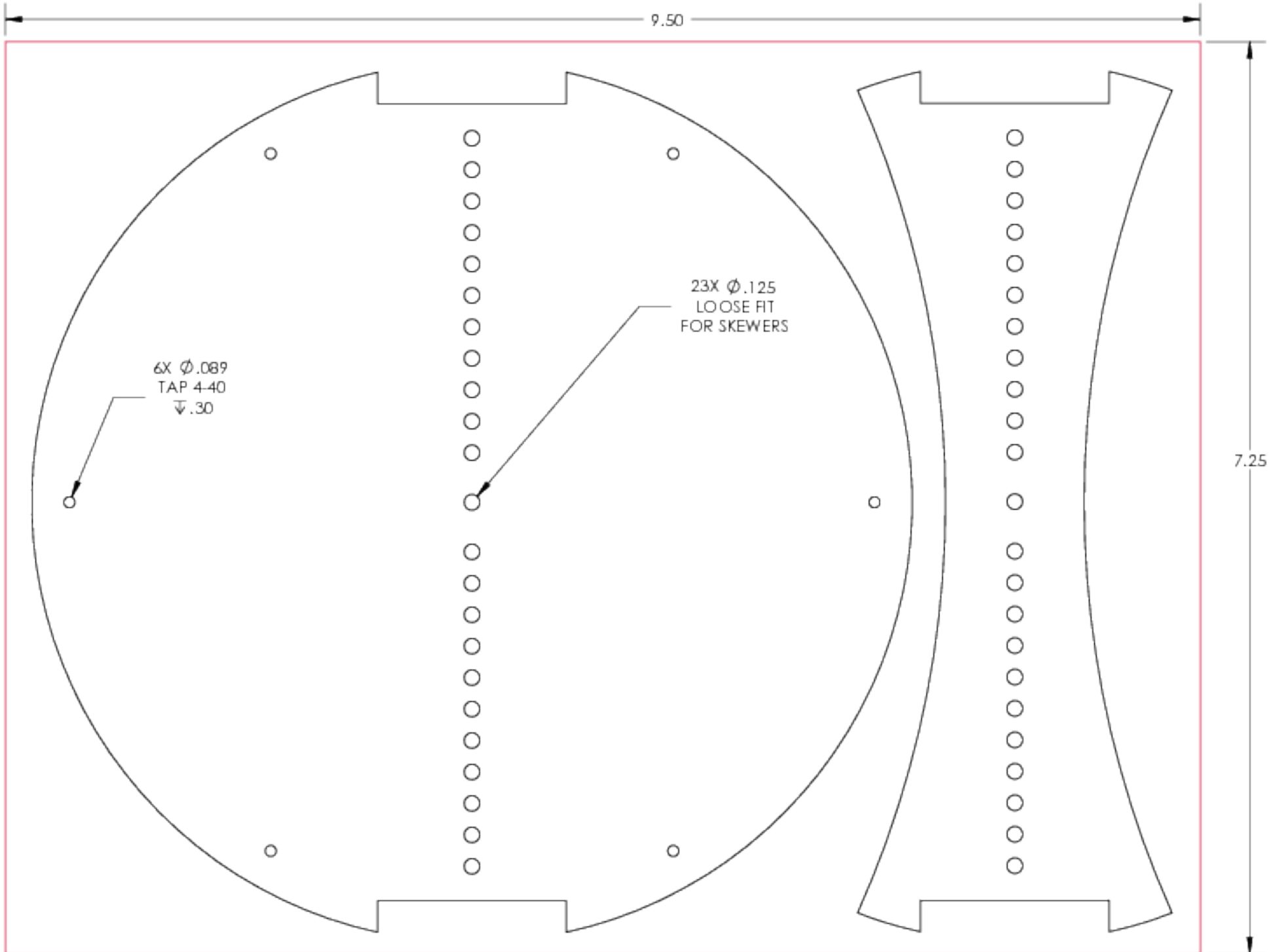

Note: Use top guide outline for cutting bottom plate. No holes in bottom plate.

# Plate cutting layout 1/2" Baltic Birch

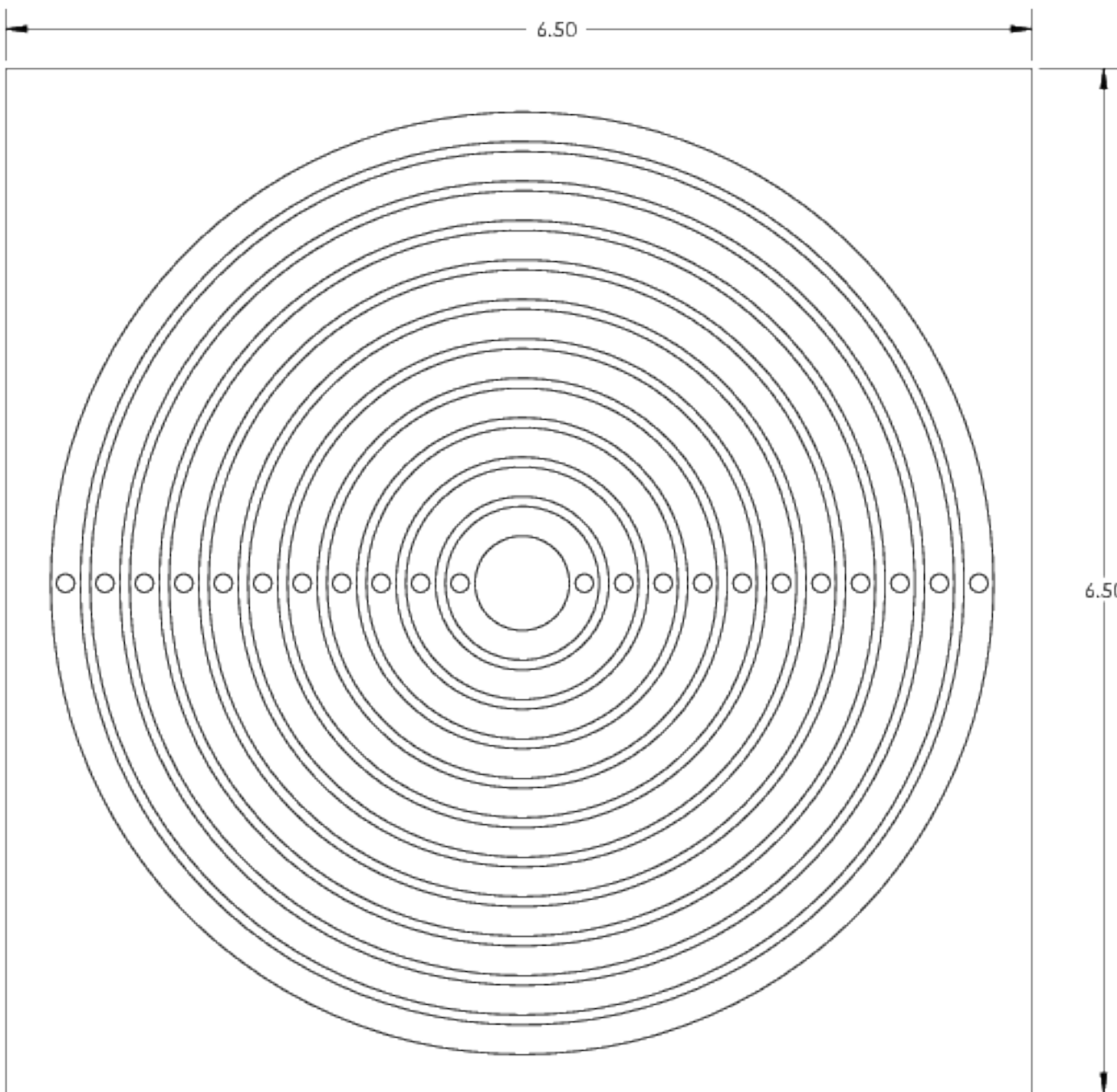

Ring cutting layout  
1/8" Baltic Birch



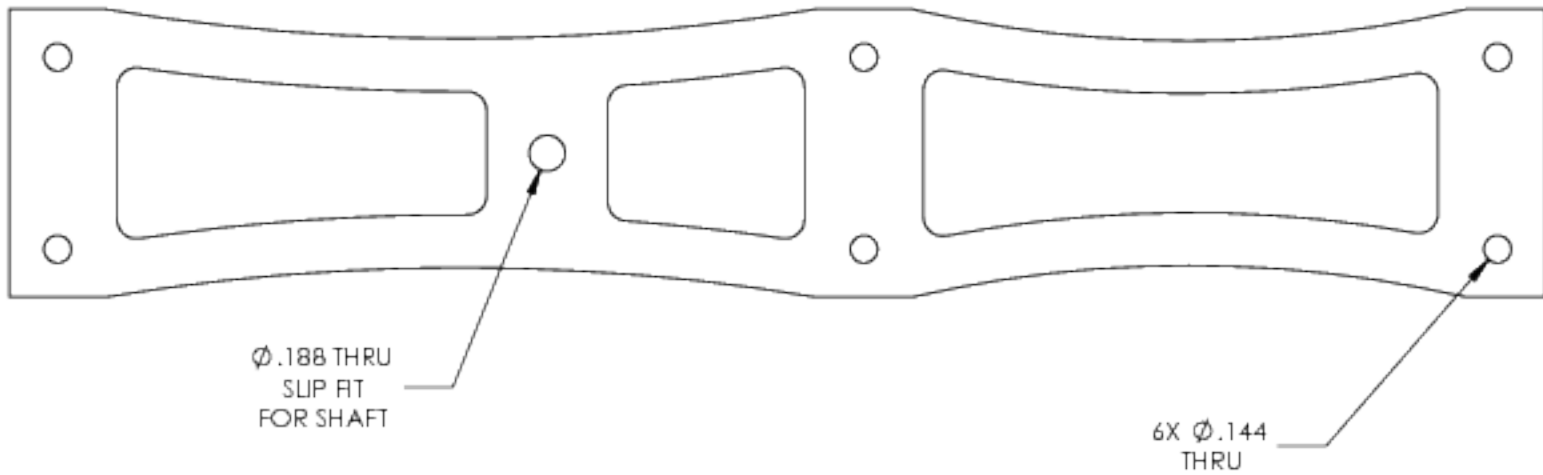

Side Bar 2 req'd  
1/4" Oak

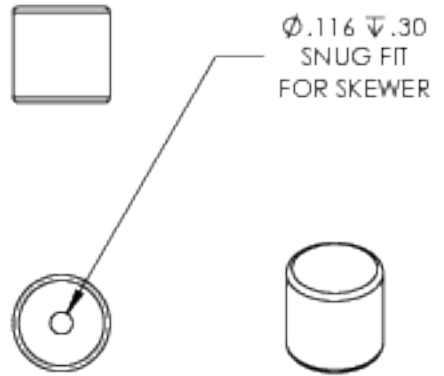

Drop  
1/2" Baltic Birch

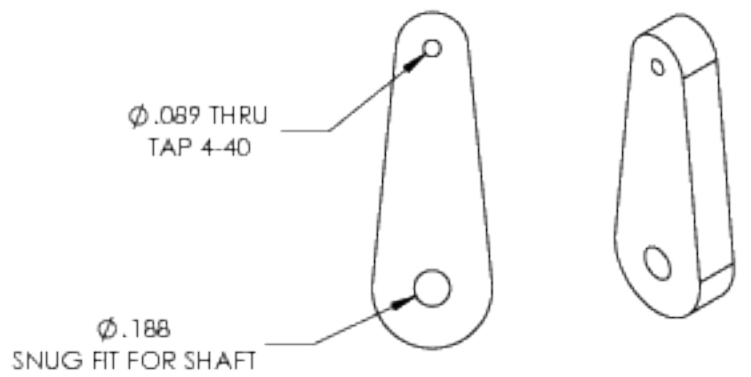

Crank  
1/4" Oak

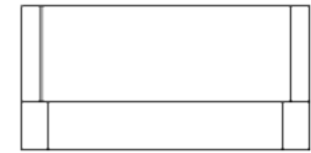
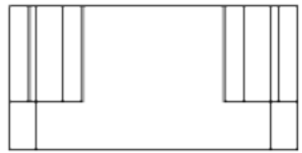

$\phi$ .089  
TAP 4-40  $\nabla$ .188

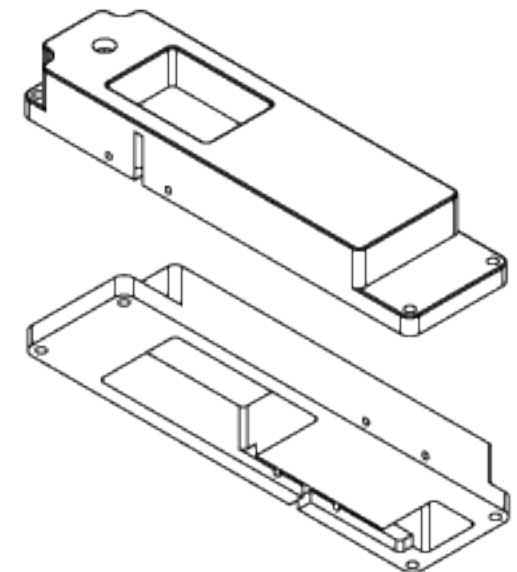
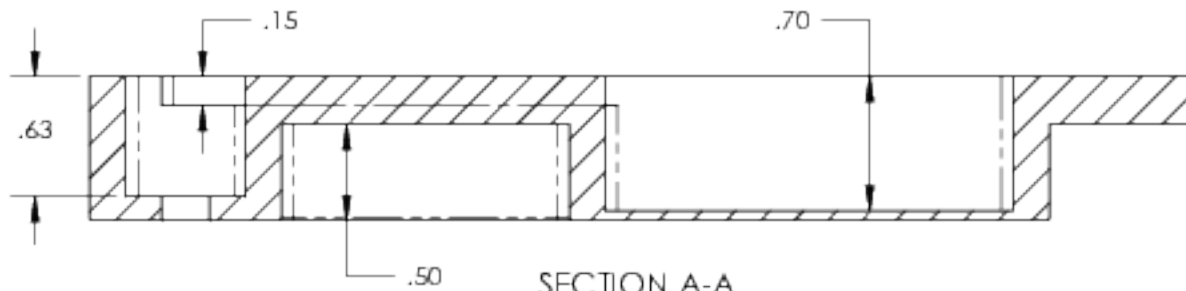
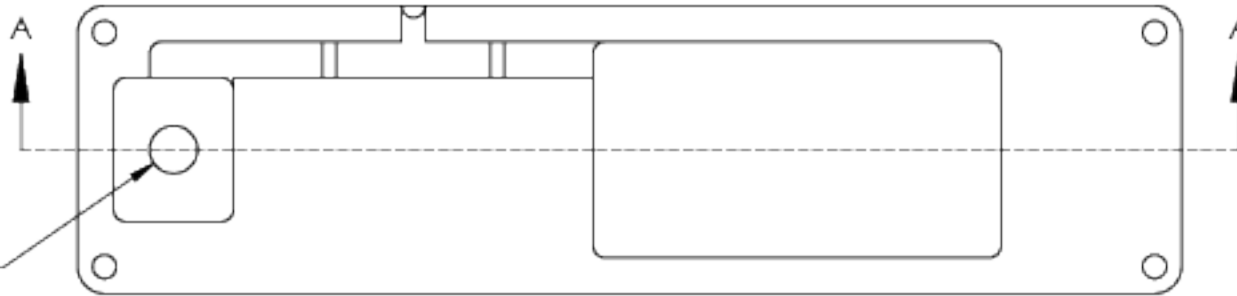

# Drive Box 3/4" Oak

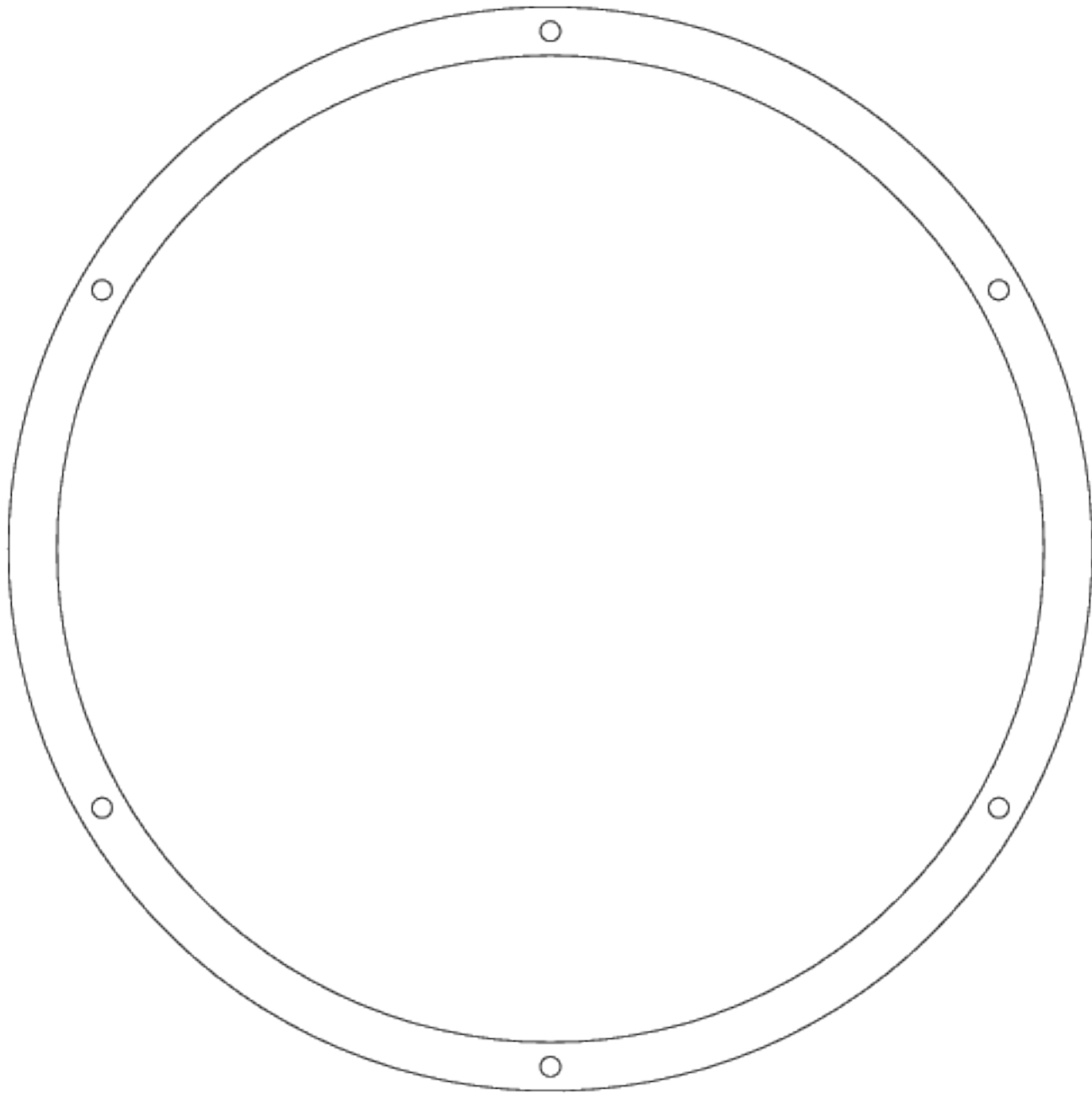

Rim 1/4" MDF