

ITEM NO.	PART NUMBER	QTY.
1	Z Motor Housing A & B	1
2	Square Nuts	6
3	Bottom Z Rod Brace	1
4	M3 Pan Head x 18mm	4
5	M3 Pan Head x 10mm	8
6	NEMA17 Stepper Motor	1
7	Vinyl tubing - 3cm x 6.35mm x 4.32mm	1
8	M3 Hex Nut	4
9	M3 Washer	4

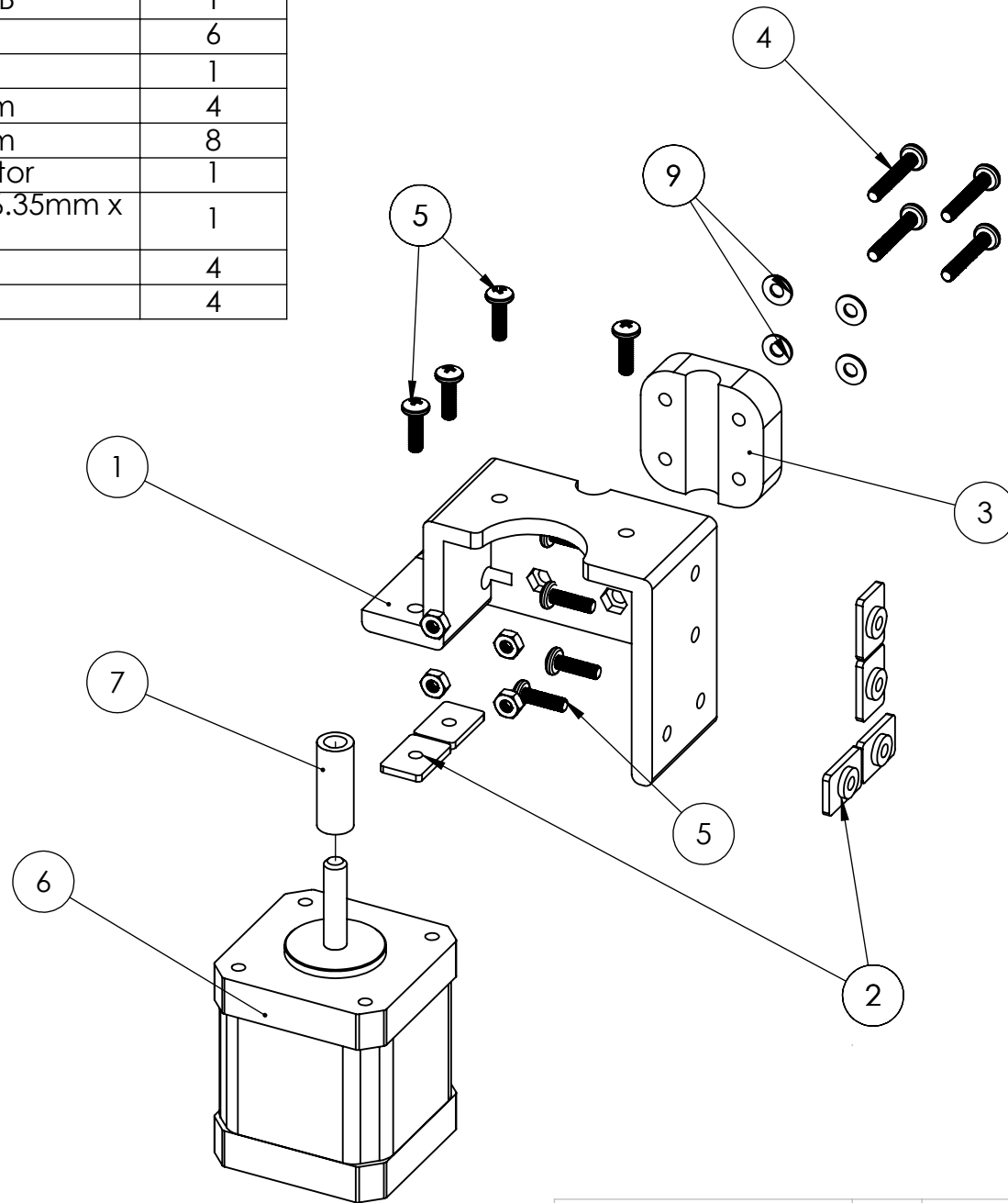

COMMENTS:	SIZE	TITLE:	REV
	A	Z Motor	
	SCALE: 1:4		SHEET 1 OF 1