

## Camera controls

<b>Tumble</b>	<b>Alt</b> +			<b>Previous View</b>	<b>(</b>
<b>Pan</b>	<b>Alt</b> +	(Click + move)	<b>Alt</b> + <b>Shift</b> +	<b>Next View</b>	<b>)</b>
<b>Zoom</b>	<b>Alt</b> +	(Scroll)	<b>Alt</b> + <b>Ctrl</b> +	<b>Wireframe</b>	<b>W</b>
	(Meshmixer default)	(123D Design)	(Pen-friendly)	<b>Boundaries</b>	<b>Ctrl</b> + <b>B</b>

## Selection Tool

<b>Select All</b>	<b>Ctrl</b> + <b>A</b>
<b>Connected</b>	<b>E</b>
<b>Invert</b>	<b>I</b>
<b>Expand</b>	
<b>Deselect</b>	<b>Shift</b> +
<b>Brush Size</b>	or <b>[</b> / <b>]</b>

## Tools

<b>Select Faces</b>	<b>S</b>	<b>Discard</b>	<b>X</b>
<b>Transform</b> (object or selection)	<b>T</b>	<b>Erase &amp; Fill</b>	<b>F</b>
<b>SurfaceBrush</b>	<b>1</b>	<b>Smooth Loop</b>	<b>B</b>
<b>SmoothBrush</b>	<b>2</b>	<b>Cancel</b>	<b>Space</b>
<b>VolumeBrush</b>	<b>3</b>	<b>Accept</b>	<b>Enter</b>

## Hotbox

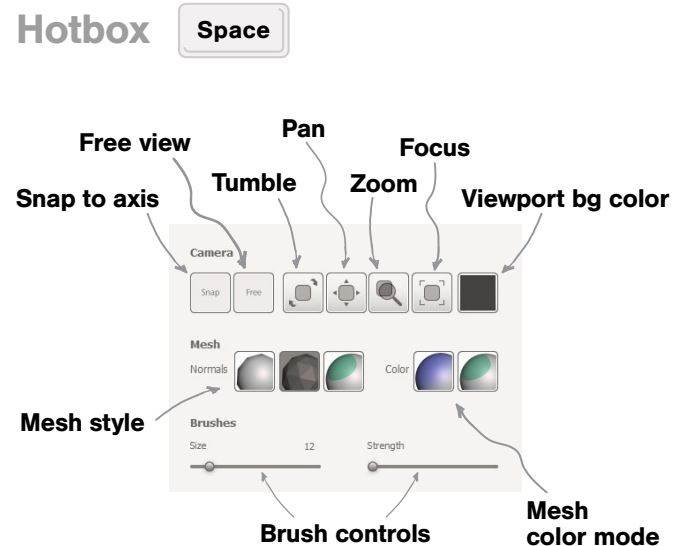

## Brushing

<b>Primary</b>	
<b>Secondary</b>	<b>Shift</b> +
<b>Invert</b>	<b>Ctrl</b> +
<b>Strength</b>	

## Notes:



Autodesk Meshmixer

CheatSheet v2.0 [www.123dapp.com/meshmixer](http://www.123dapp.com/meshmixer)